

TANCO AUTOWRAP  
CUT AND START  
OPERATORS HANDBOOK  
AND  
PARTS LIST

TANCO AUTORAP

CUT AND START

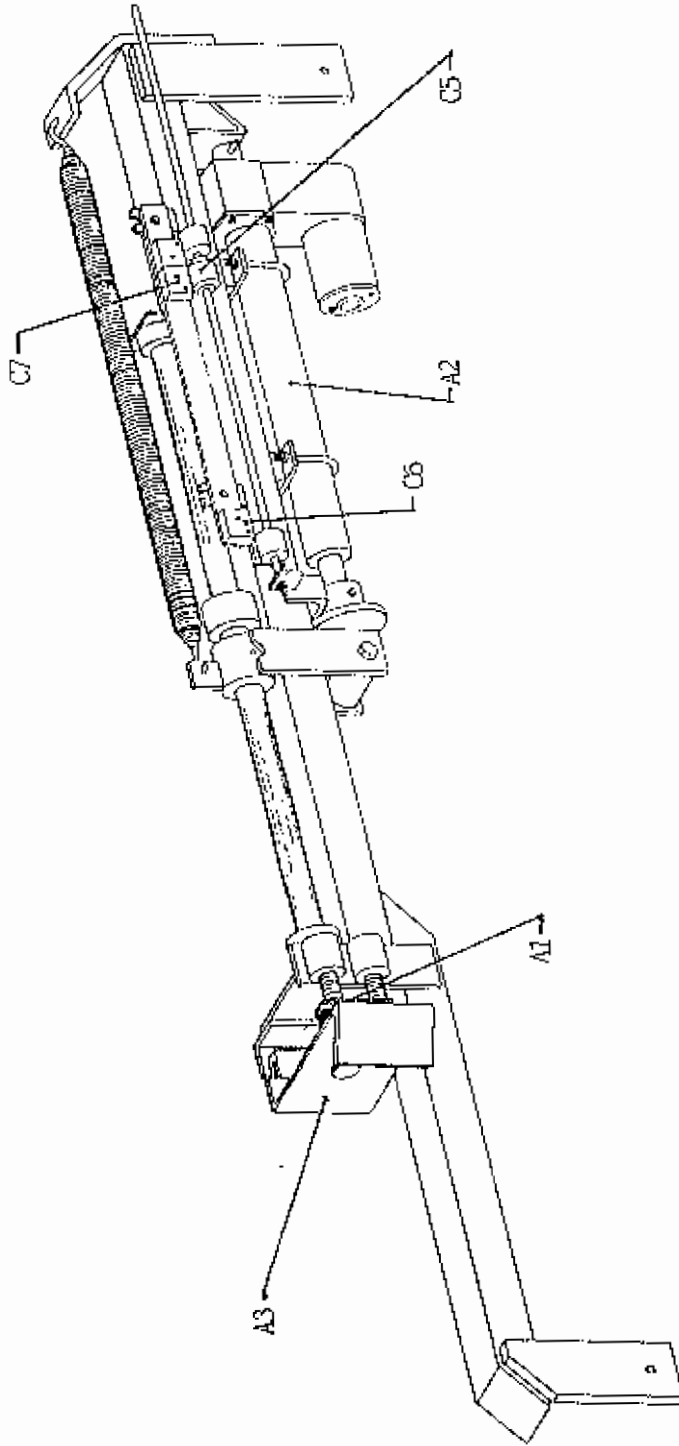

Fig. A

Tanco © 1969

Tanco Autowrap

Out and Start

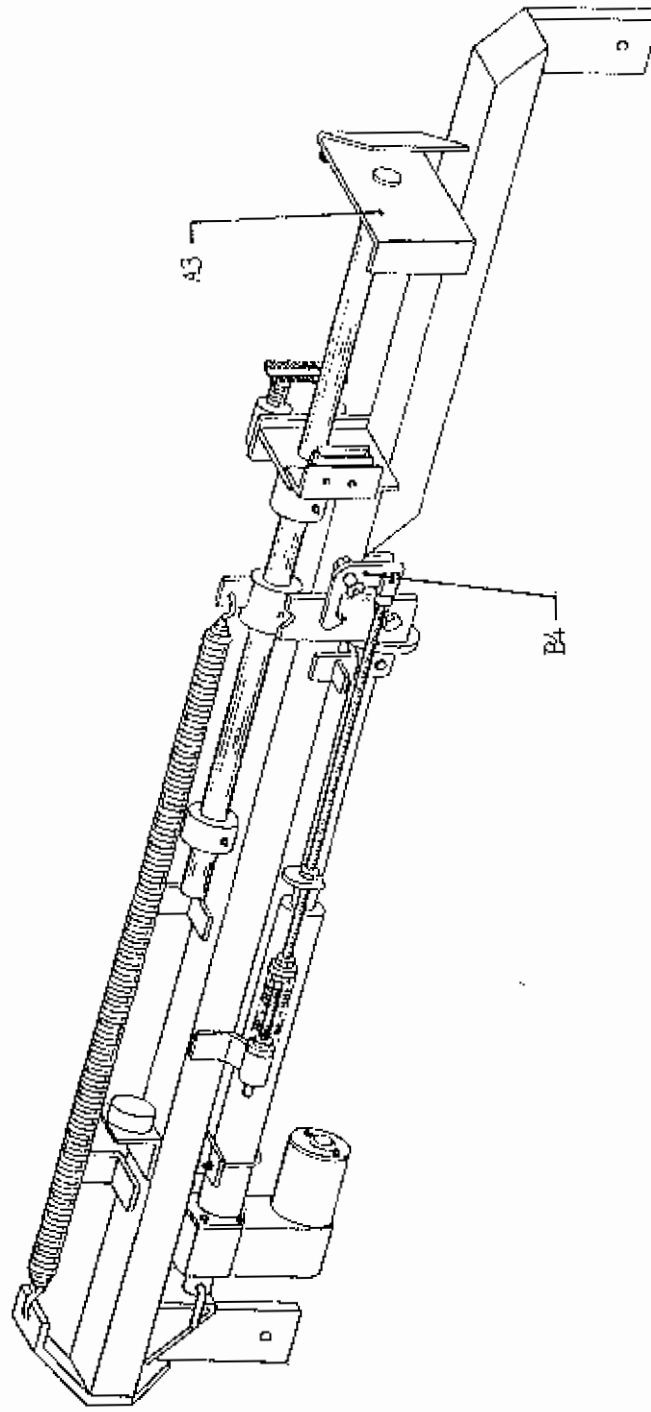

Fig. B

TANCO AUTOMAP  
OUT AND START

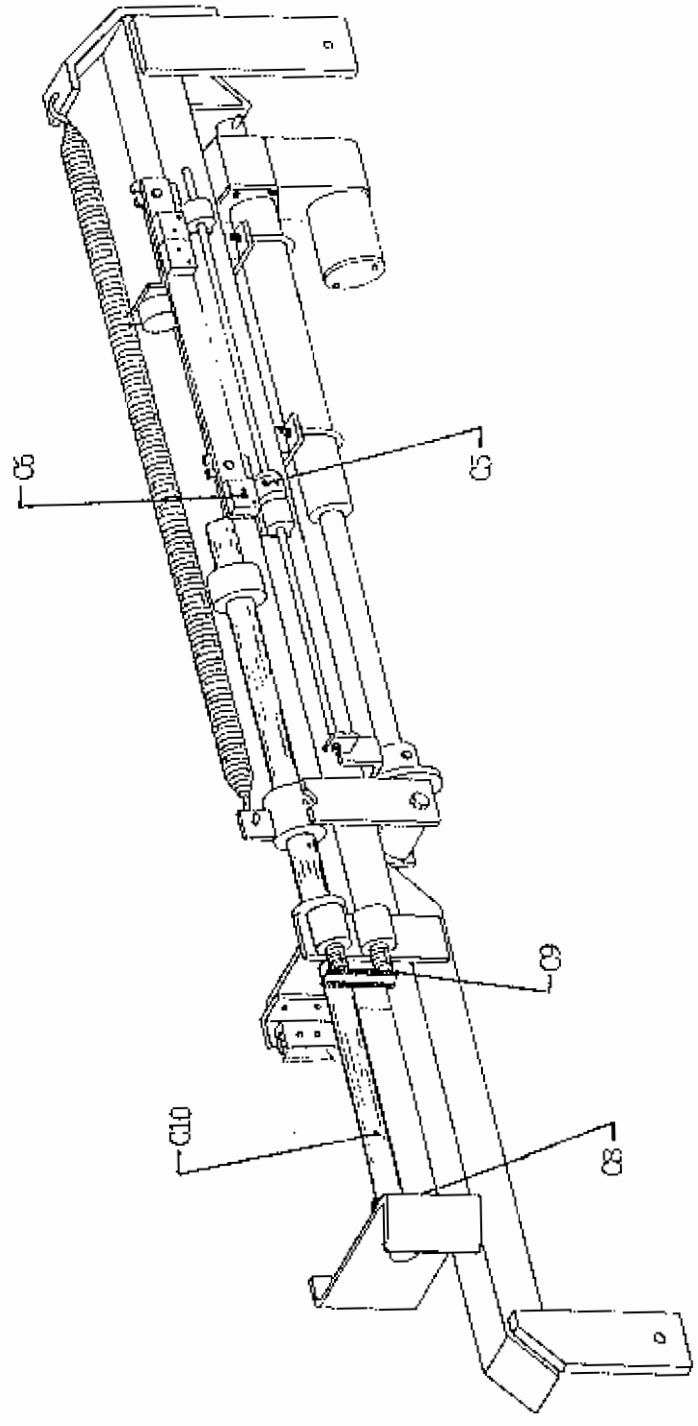

Fig. C

TAMCO AUTOMAT

OUT AND START

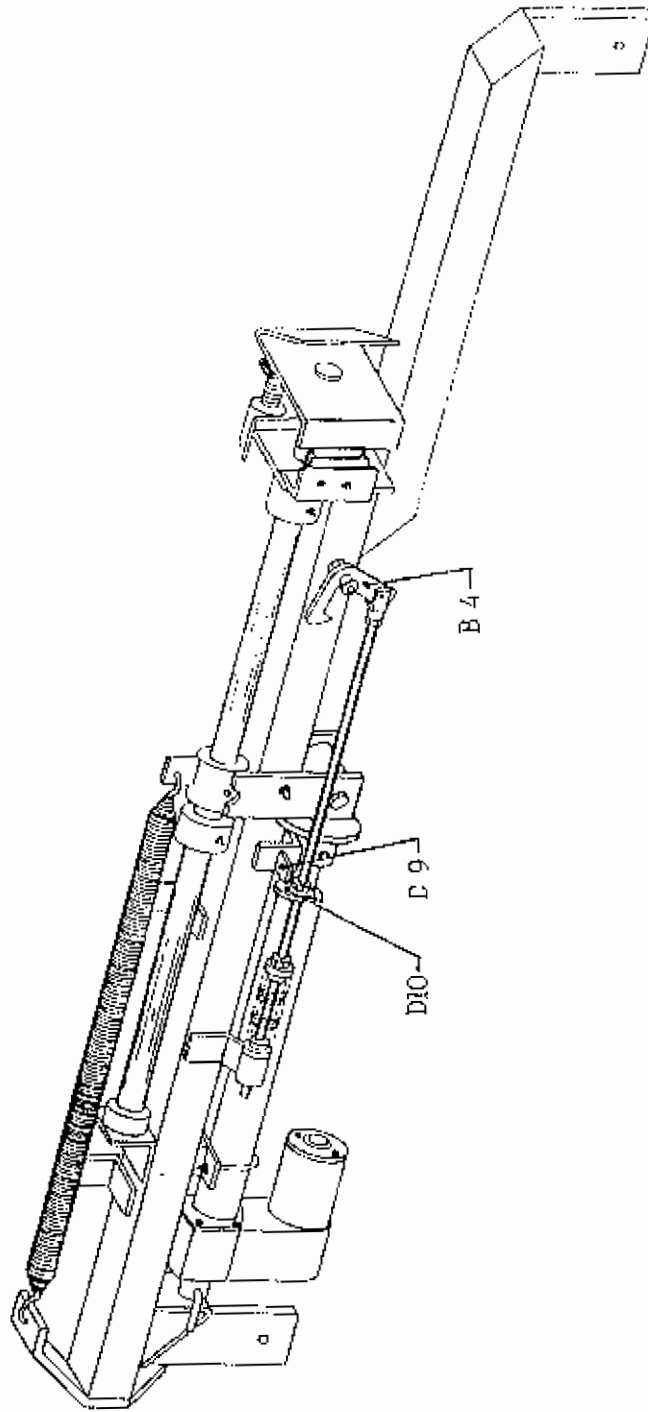

Fig. D

TANCO AUTOWRAP CUT AND START UNITPARTS LIST

<u>ITEM NO.</u>	<u>DESCRIPTION</u>	<u>QTY.</u>	<u>PART NO.</u>	<u>CODE NO.</u>
1.	MAIN MOUNTING FRAME ASSY.	1	B/R 250 A	
2.	LATCH ASSY.	1	B/R 252 A	
3.	PUSH PLATE ASSY.	1	B/R 253 A	
4.	GUIDE ASSY.	1	B/R 254 A	
5.	PLUNGER ASSY.	1	B/R 255 A	
6.	FILM GRIPPER ASSY.	1	B/R 256 A	
7.	MICRO SWITCH MOUNTING PLATE	1	B/R 258 A	
8.	WARNER LINEAR ACTUATOR D11 10BS 08 NO CLUTCH 12V	1		20605-500
9.	"0" BOLT	1	B/R 259	
10.	STEPPED COLLAR	2	B/R 260	
11.	SLEEVE 1/2" DIA O.D. x 13/32" DIA I.D.	1	B/R 261	
12.	THREADED ROUND 5/16" UNF	1	B/R 262	
13.	TRIGGER	1	B/R 263	
14.	COLLAR 1" DIA BRIGHT RD. x 41.5mm LONG	1	B/R 264	
15.	COLLAR 1 1/8" DIA BRIGHT RD.	1	B/R 265	
16.	BLADE GUARD	1	B/R 266	
17.	BLADE MOUNTING BRACKET	1	B/R 267	
18.	BLADE CLAMPING PLATE	1	B/R 268	
19.	1.0mm BRIGHT RD.	1	B/R 271	
20.	SPRING 1.6mm O.D. x 1.5mm WIRE x 48mm LONG	1		
21.	SPRING 16.5mm O.D. x 1.5mm WIRE x 40mm LONG	2		
22.	SPRING 25mm O.D. x 2.5mm WIRE x 325mm	1		
23.	OILITE OIL RETAINING BUSH 1 1/8" O.D. x 3/4" I.D. x 1" L.	3		
24.	RUBBER BUFFER 40mm DIA	1		740-24
25.	CLEVIS C/W PIN	1		249-33
26.	1 1/2" x 1/4" DIA TENSION PIN	1		203-20-07
27.	1/8" BSP ST GREASE NIPPLE	2		239-60
28.	M6 GRUB SCREW	1		
29.	M12 HEX HD BOLT x 65mm	1		226-08R2B
30.	M12 HEX HD BOLT x 50mm	1		226-086B
31.	M10 HEX HD SET x 30mm	2		226-062S
32.	M6 HEX HD SET x 20mm	4		226-020S
33.	M12 BINX LOCKNUT	4		223-12
34.	M8 HEX NUT	2		218-08

TANCO AUTOWRAP CUT AND START UNIT

PARTS LIST

<u>ITEM NO.</u>	<u>DESCRIPTION</u>	<u>QTY.</u>	<u>PART NO.</u>	<u>CODE NO.</u>
35.	5/16" UNF HEX NUT	7		Z15-05
36.	M6 HEX NUT	6		Z18-06
37.	M6 LOCKNUT (NYLOCK)	4		Z23-16
38.	10mm DIA FLAT WASHER	6		Z11-02-10
39.	8mm DIA FLAT WASHER	1		Z11-02-08
40.	6mm DIA FLAT WASHER	4		Z11-02-06
41.	6mm DIA SPRING WASHER	8		Z12-02-06
42.	3mm DIA SPLIT PIN	2		
43.	BLADE	1		
44.	MAIN GUARD	1	B/R 269 A	
45.	M6 HEX HD SET x 16mm LONG	4		
46.	10mm DIA SPRING WASHER	2		Z12-02-10
47.	M10 HEX NUT	2		Z18-10
48.	8mm DIA SPRING WASHER	3		Z12-02-08
49.	JOIN DEERE LIGHTS EDGING	1		
50.	SPACER 1" O.D. x 1/2" T.D. x 6mm LONG	2	B/R 275	
51.	M10 HEX HD SET x 20mm	2		Z26-0605
52.	6mm DIA FLAT WASHER 1" O.D.	4		Z11-02-061

TANCO AUTOWRAP  
CUT AND START UNIT  
MAIN ASSEMBLY

076 36248

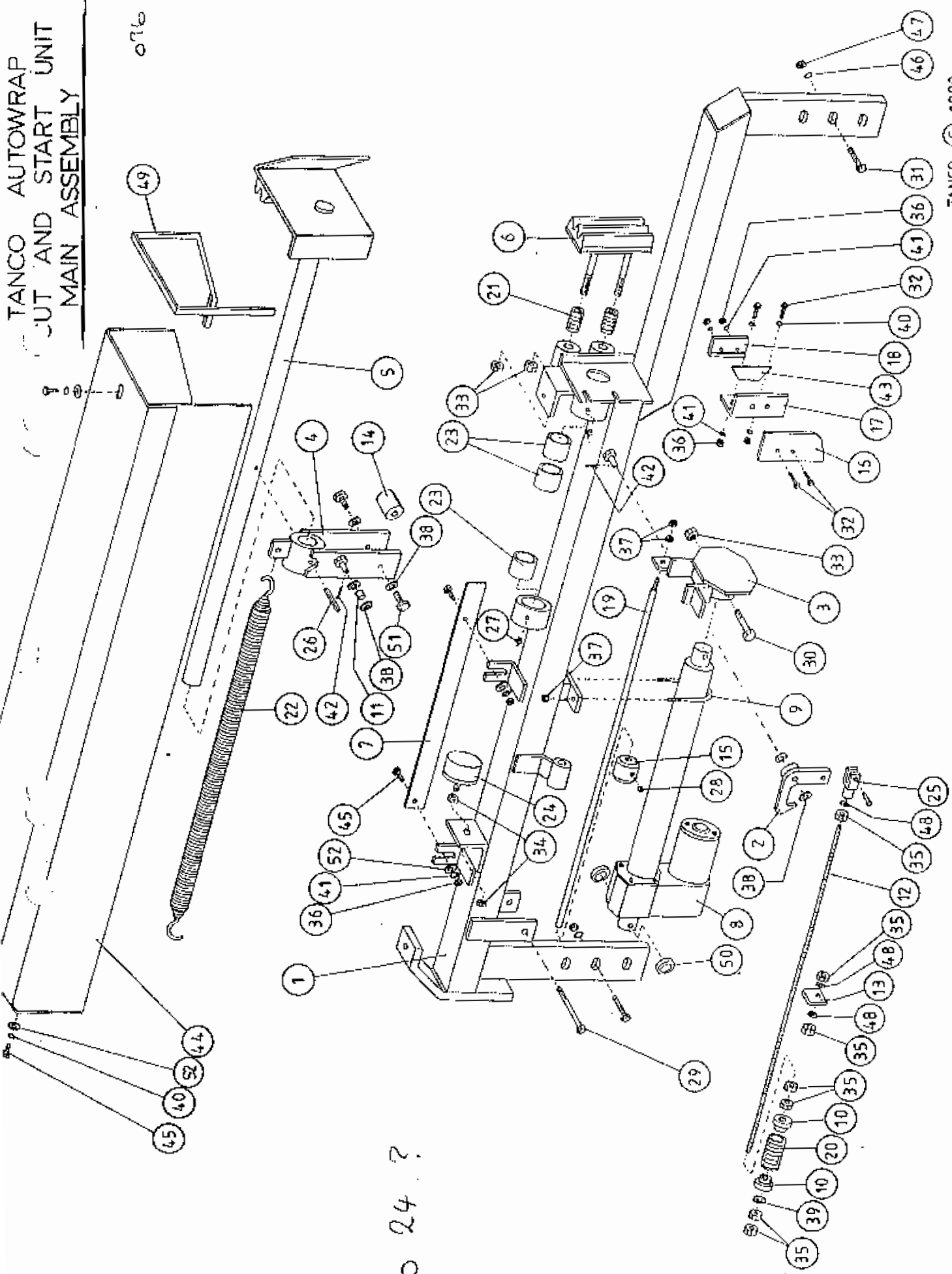

No 24 ?



TANKS AUTO WRAP CUT AND START  
 SENSOR MOUNTING BRACKET  
 MAGNET MOUNTING BRACKET.

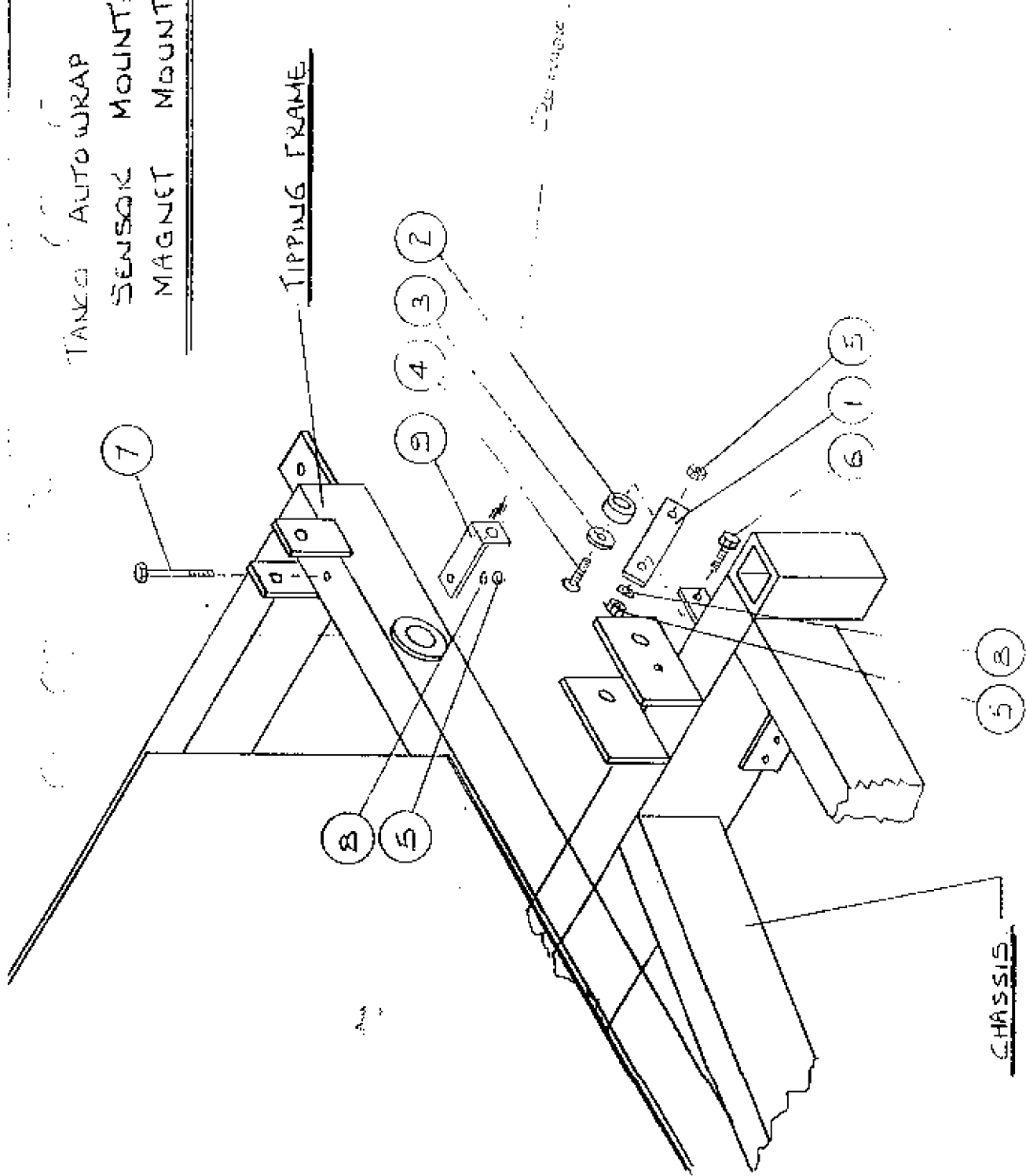

TANCO AUTOWRAP CUT AND START UNIT

SENSOR AND MAGNET MOUNTING BRACKETS

PARTS LIST

<u>ITEM NO.</u>	<u>DESCRIPTION</u>	<u>QTY.</u>	<u>PART NO.</u>	<u>CODE NO.</u>
1	MAGNET MOUNTING FLAT	1	B/R 272	
2	MAGNET 35mm O.D. x 17mm I.D. x 8mm LONG	1		
3	6mm DIA FLAT WASHER 1" O.D.	1		
4	M6 CS'K SET SCREW x 25mm	1		Z13-131
5	M6 LOCKNUT (NYLOCK)	3		Z23-06
6	M6 HEX HD SET x 20mm	1		Z26-0205
7	M6 HEX HD BOLT x 100	1		
8	6mm DIA FLAT WASHER	2		Z11-02-06
9	SENSOR MOUNTING BRACKET	1	B/R 273	